

Spare Parts Diagram

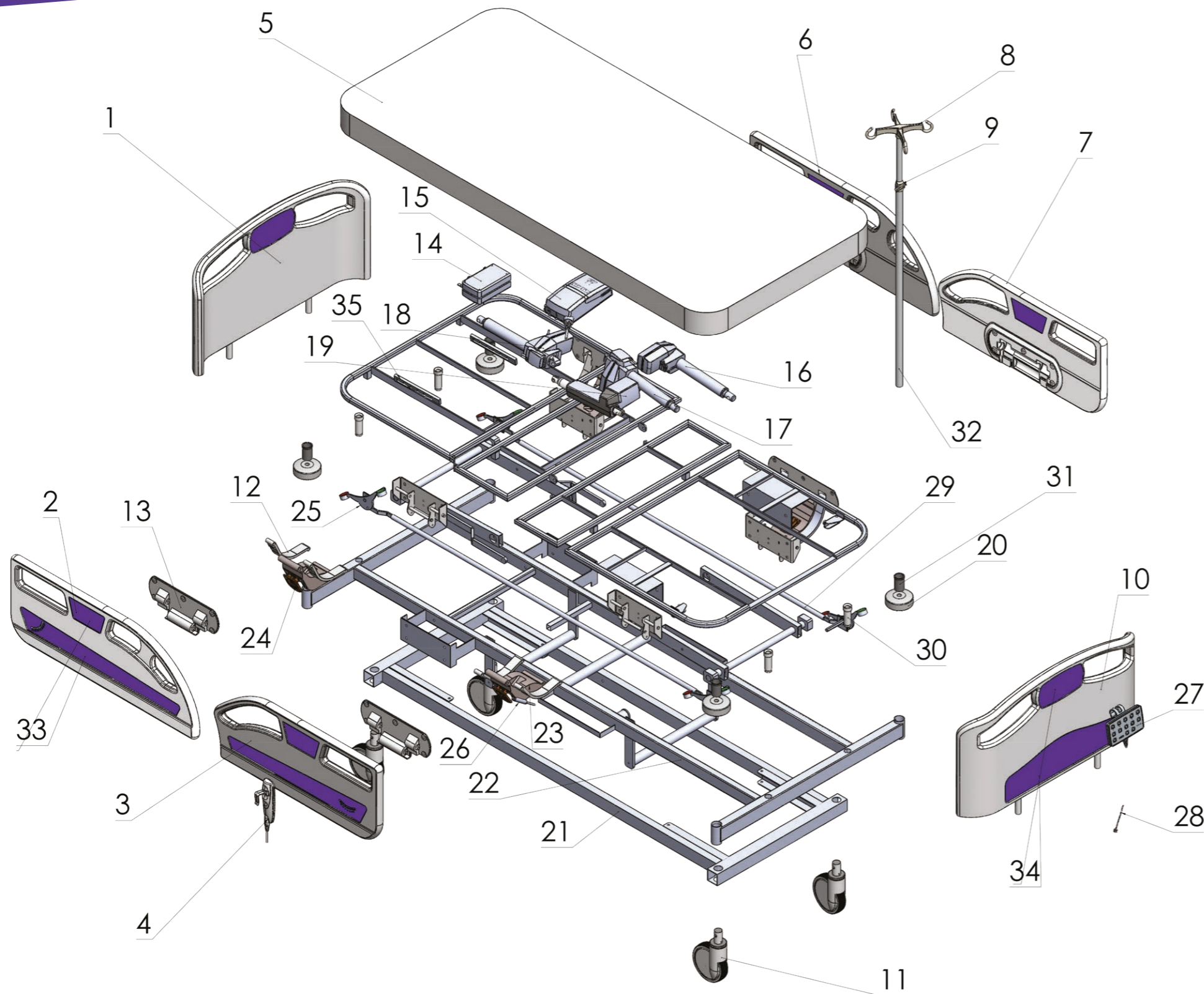

Part No	Part Name
1	Headboard
2	Head part right side rail
3	Foot part right side rail
4	Hand control unit
5	Mattress
6	Head part left side rail
7	Foot part left side rail
8	IV hooks (plastic)
9	IV adjusment screw
10	Footboard
11	Central lockable castor 150mm / directional locable caster
12	Siderail mechanism holder (aluminum)
13	Siderail inner cover
14	Battery
15	Control box (power supply)
16	High/ low actuator
17	High/ low actuator
18	Backrest actuator with cpr
19	Lagrest actuator
20	Bumper
21	Subframe
22	Topframe
23	Siderail mechanism
24	Siderail reliase handle
25	Central locking pedal
26	Damper for siderail
27	Nurse control unit
28	Power cord
29	Central lock transmitter
30	Headaboard plastic holder
31	IV holder
32	IV pool
33	Colour sticker for siderail
34	Colour sticker for fb/hb
35	Stair rail